

Sno-Way Quick Tach Conversion Kits

Use existing ST / MT / HT snow plows with new subframe

Sno-Way 22 Series Quick Tach Conversion Kit P/N 99100925

This conversion kit will allow Sno-Way ST model plows to fit 22 model subframes.

Sno-Way 26 Series Quick Tach Conversion Kit P/N 99100851

This conversion kit will allow Sno-Way 24, 25, MT and HT model plows to fit 26 model subframes and Vehicle Center Member.

Sno-Way 29 / 32 Series Quick Tach Conversion Kit P/N 99100743

This conversion kit will allow Sno-Way 24, 25, MT, HT, 28D, HTV model plows to fit 29 / 32 model subframes and Vehicle Center Members.

All Quick Tach Conversion Kits Include:

- Light Bar Assembly & Light Bar Supports
- Quick Attach Light/Lift Bar Assembly
- Lift Link
- Jackstand Assembly
- Complete Assembly Hardware, Fasteners & Pins
- Owner's, Installation & Parts Manual

**EIS PLOW LIGHT HARNESS CONVERSION KIT
96110119 IS SOLD SEPERATELY**

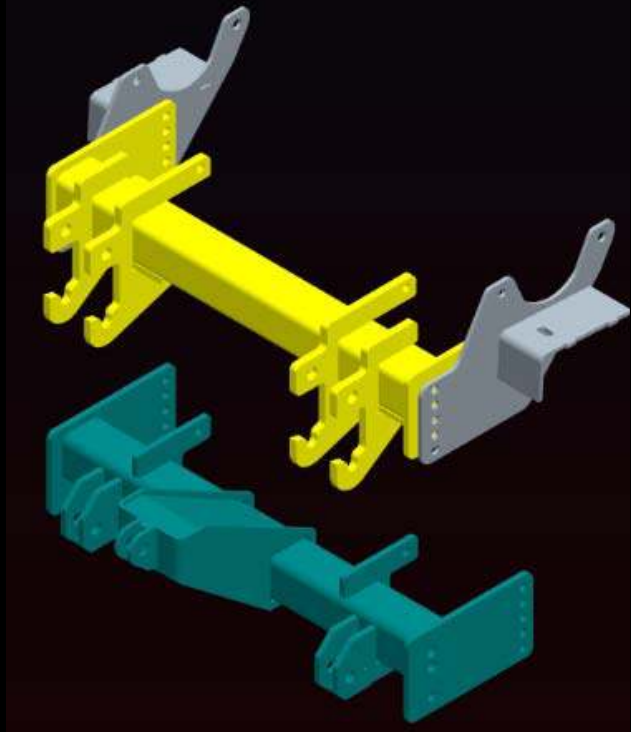

Sno-Way VCM Conversion Kits

Sno-Way 26 Series VCM Conversion Kit P/N 99101170

This conversion kit (green) will allow Sno-Way 24, 25, MT and HT model plows to fit 26 model subframes by replacing the standard Vehicle Center Member (yellow). This kit may require more bumper modifications than Quick Tach Conversion Kit 99100851.

Sno-Way 29 / 32 Series VCM Conversion Kits P/N 99101171, 99101172, 99101173, or 99101174

This conversion kit (green) will allow Sno-Way 24, 25, MT, HT, 28D, HTV model plows to fit 29 / 32 model subframes by replacing the standard Vehicle Center Member (yellow). This kit may require more bumper modifications than Quick Tach Conversion Kit 99100743.

Standard 29/32 Series Vehicle Center Member	Conversion Kit to replace the Vehicle Center Member
99100891	99101171
99100892	99101172
99100950	99101173
99101139	99101174

All Vehicle Center Member Conversion Kits Include:

- 3 Point Vehicle Center Mount
- Complete Assembly Hardware, Fasteners & Pins
- Installation Manual

**EIS PLOW LIGHT HARNESS CONVERSION KIT
96110119 IS SOLD SEPERATELY**