



**Assembly  
&  
Installation Instructions**

**FOR**  
**SUBFRAME COMPONENTS PACKAGE 99100416**

**TO FIT**  
**1999 & Later Isuzu Trooper**



1. **THINK SAFETY, ALWAYS WEAR SAFETY GLASSES WHEN PERFORMING THE OPERATIONS PRESCRIBED IN THESE INSTRUCTIONS**
2. **READ ALL INSTRUCTIONS CAREFULLY BEFORE ATTEMPTING INSTALLATION**
3. **BEFORE BEGINNING WORK MAKE SURE TO SET PARKING BRAKE AND CHOCK WHEELS**



### MINIMUM VEHICLE RECOMMENDATIONS

Heavy Duty Alternator  
Heavy Duty Battery

### ASSEMBLY TOOLS NEEDED

Impact Sockets 7/16" – 1-3/8"  
Metric Sockets 10 mm – 19 mm  
Wrenches 7/16" – 1-3/8"  
Metric Wrenches 10 mm – 19 mm  
Torque Wrench  
Hammer  
Rat Tail Pry Bar

### INSTALLATION NOTES

1. Unless otherwise specified, mount all Sub-Frame Components to vehicle before tightening any hardware.
2. It is recommended that **LOCTITE®**, or similar thread locking product, be used on **ALL** mounting hardware (i.e. Nuts, Cap Screws, Bolts, etc.).
3. Vehicle should be parked on a level surface with a normal vehicle load on the FRONT suspension.
4. Items in parentheses ( ) refer to quantity required for this step. Items in parentheses with a pound sign (#) indicate the part number as found in the parts list on the last page of this document.  
Example: (2) 5/8" x 1-1/2" Cap Screws (#9).
5. It may be necessary to relocate license plate holder. Check state and local laws for placement, if needed.

**IMPORTANT: Height from the center of the lower plow mounting holes on the sub-frame to the ground should be between 9" and 11" to insure proper operation.**

5. Install (1) Mounting Bracket, LH (#2). Secure using (2) 1/2" x 1.50 Capscrews (#9) and (2) 1/2" Nylock Nuts (#8). Between the Mounting Bracket and the frame, insert (1) Spacer, .50 (#5) ensuring that the holes are all in alignment. Secure using (1) 1/2" x 4.50 Capscrews (#6), (1) 1/2" Flat Washer (#10), and (1) 1/2" Nylock Nut (#8).
6. Install (1) Mounting Bracket, RH (#3) using the same procedure as in Step #5.
7. Using the Torque Specification Chart below, torque all Capscrews starting at the rear and working forward.

### MOUNTING INSTRUCTIONS

1. Remove tow hooks. Retain, with hardware, for use if sub-frame is removed.
2. Remove splash shield from the underside of the vehicle. Retain, with mounting hardware, for use if sub-frame is removed
3. Install (1) Mounting Assembly (#1) first by securing the tow hook mounts using (4) M10-1.25 x 30 Capscrews (#7).
4. Insert (2) Spacer, .25 (#4) between the frame and the Mounting Assembly (both sides) ensuring that the holes line up in the frame and the Mounting Assembly.

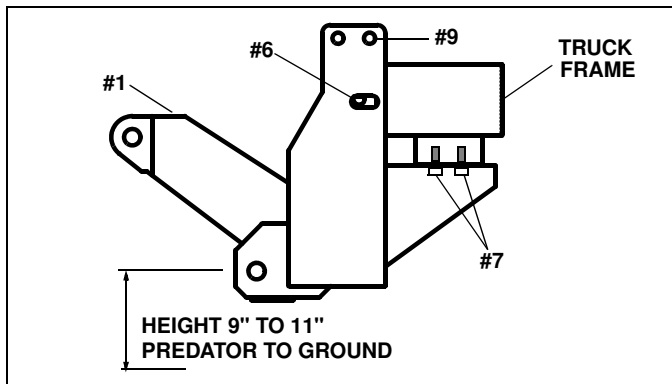

### TORQUE SPECIFICATIONS FOR STANDARD MACHINE HARDWARE

Bolt Size	GR.2 Dry	GR.5 Dry	GR.8 Dry	Metric Size	GR.8.8 Dry
1/4"	66*	9	12	M8	17
5/16"	11	17	25	M10	35
3/8"	20	30	45	M12	60
7/16"	32	50	70	M14	95
1/2"	50	75	110	M16	155
9/16"	70	110	150		
5/8"	100	150	220		
3/4"	175	260	380		
7/8"	170	430	600		
1"	250	640	900		

Note: These torque values are to be used for all hardware. Unless otherwise specified, all torque values must meet this specification.  
Note: All torque values are in Ft.-Lbs unless otherwise stated  
Note: \*In-Lbs

**REMEMBER After 5 to 10 hours of snowplow usage, re-torque all Cap Screws!**

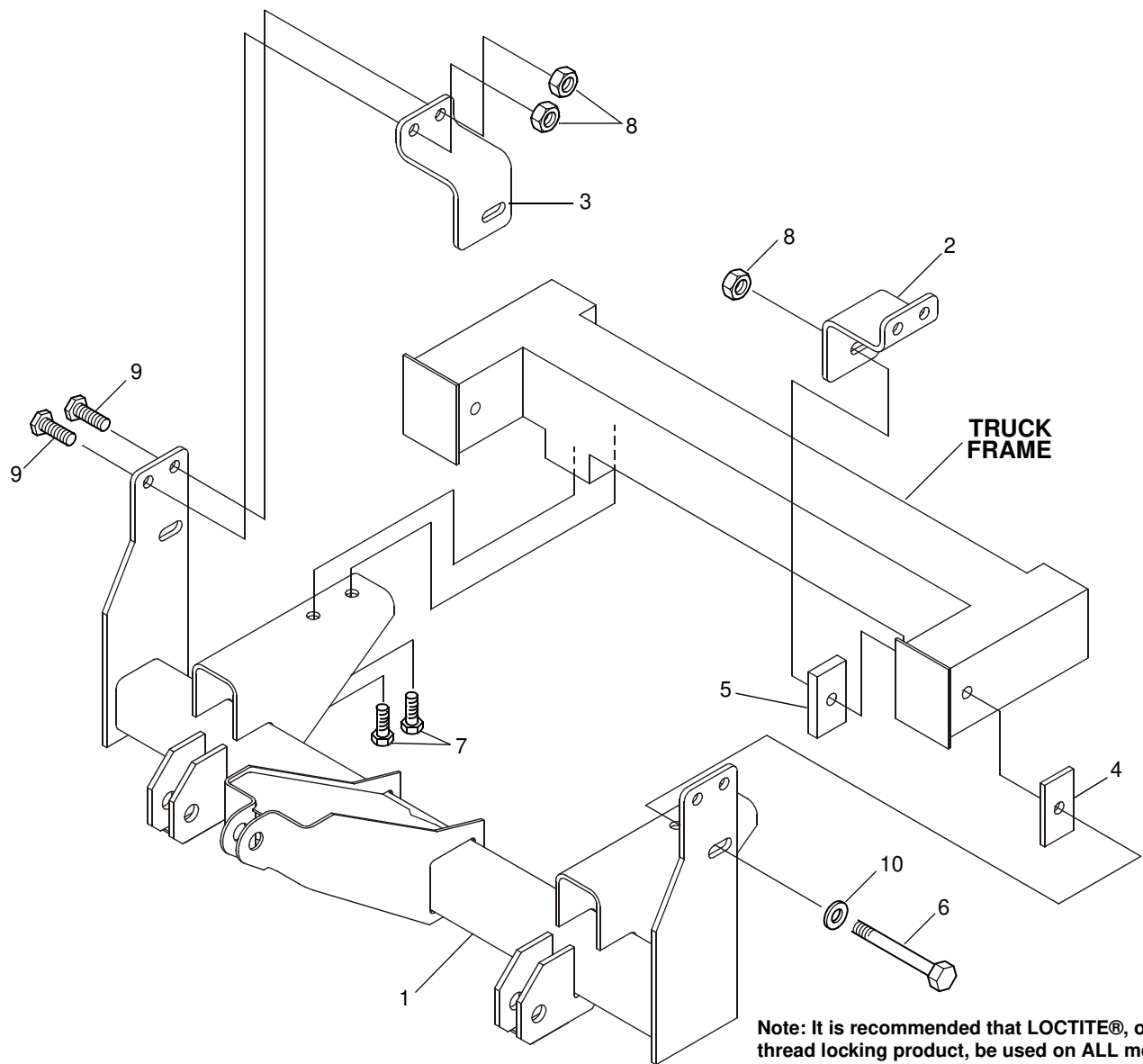

**Note:** It is recommended that LOCTITE®, or similar thread locking product, be used on ALL mounting hardware (i.e. Nuts, Cap Screws, Bolts, etc.).

ITEM	PART NO.	DESCRIPTION	QTY.
1	96104526	Assembly, Mounting .....	1
2	96104532	Bracket, Mounting, LH .....	1
3	96104533	Bracket, Mounting, RH.....	1
4	96104555	Spacer, .25.....	2
5	96104556	Spacer, .50.....	2
6	98009055	Capscrew, Hex Head, 1/2"-13NC x 4.50.....	2
7	98100203	Capscrew, Metric, M10-1.25 x 30 .....	4
8	98009013	Nut, Hex, 1/2"-13NC, Nylock.....	6
9	98009010	Capscrew, Hex Head, 1/2"-13NC x 1.50.....	4
10	98009014	Washer, Flat, 1/2" .....	2

---

**SNO-WAY® INTERNATIONAL, INC.**



©2001 Sno-Way® International