

SNO-WAY®

SNOW & ICE CONTROL EQUIPMENT

ASSEMBLY & INSTALLATION INSTRUCTIONS

**VEHICLE MOUNT KIT 99101518 AND
VEHICLE CENTER MEMBER 96114780**

TO FIT
2025 & Later - Polaris Ranger XP1000, XP1000 Crew

Sno-Way®, Down Pressure® and EIS® are registered trademarks of Sno-Way International, Inc.
ProControl™, MegaBlade™, V-Wing™, E-Z Switch™, Revolution™, MaxAdjust™, SpeedLock™, and QuickJack™
are trademarks of Sno-Way International, Inc.

©2024 Sno-Way® International

97102510A



1. **THINK SAFETY, ALWAYS WEAR SAFETY GLASSES WHEN PERFORMING THE OPERATIONS PRESCRIBED IN THESE INSTRUCTIONS**
2. **READ ALL INSTRUCTIONS CAREFULLY BEFORE ATTEMPTING INSTALLATION**
3. **BEFORE BEGINNING WORK MAKE SURE TO SET PARKING BRAKE AND CHOCK WHEELS**



MINIMUM VEHICLE RECOMMENDATIONS

Heavy Duty Alternator Heavy Duty Battery

INSTALLATION NOTES

1. **Unless otherwise specified, mount all Vehicle Mount Kit components to vehicle before tightening any hardware.**
2. **It is recommended that LOCTITE®, or similar thread locking product, be used on ALL mounting hardware (i.e. Nuts, Cap Screws, Bolts, etc.).**
3. Vehicle should be parked on a level surface with a normal vehicle load on the FRONT suspension.
4. Items in parentheses () refer to quantity required for this step. Items in parentheses with a pound sign (#) indicate the part number as found in the parts list on the last page of this document.
Example: (10) Washer, Lock, 1/2" (#8).
5. It maybe necessary to relocate license plate holder. Check state and local laws for placement, if needed.

NOTE: On some vehicles it may be necessary to use a form of load booster to decrease the vehicle's front suspension sag with the snow plow in place. This can be accomplished with the use of supplementary air bags, booster springs, or similar load boosting devices. Since there are different load boosting devices available, it will up to the customer/end user to decide and purchase the product to suit the application, and not the responsibility of Sno-Way International, Inc.

ASSEMBLY TOOLS NEEDED

Impact Sockets	5/16" – 3/4"
	5mm – 16mm
Wrenches	5/16" – 3/4"
	5mm – 16mm
Drill Bits	1/4", 7/16"
Torque Wrench	
Tape Measure	

MOUNTING INSTRUCTIONS

1. Remove (2) lower Cap Screws that hold the Bumper/Brush Guard to the frame (See Figure 1).

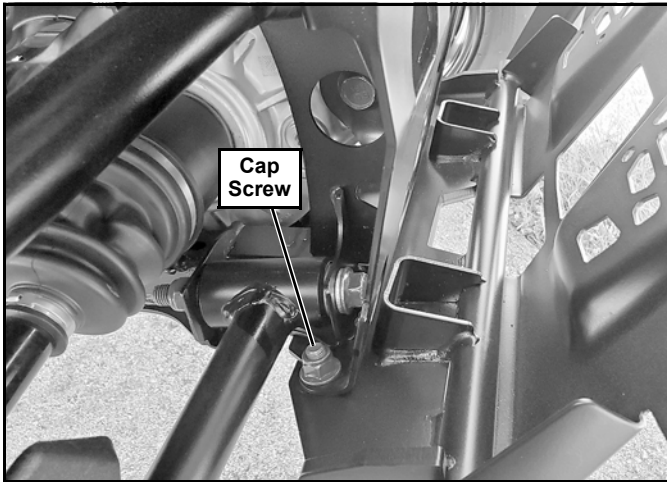

Figure 1

2. Behind the Brush Guard are four holes in the frame (See Figure 2). Align these holes with the holes in the Top Weldment (#2).

NOTE: It may be necessary to loosen (but not remove) the top two Cap Screws that hold the Bumper/Brush Guard to the frame to be able to easily insert the Top Weldment (#2) behind the Bumper/Brush Guard.

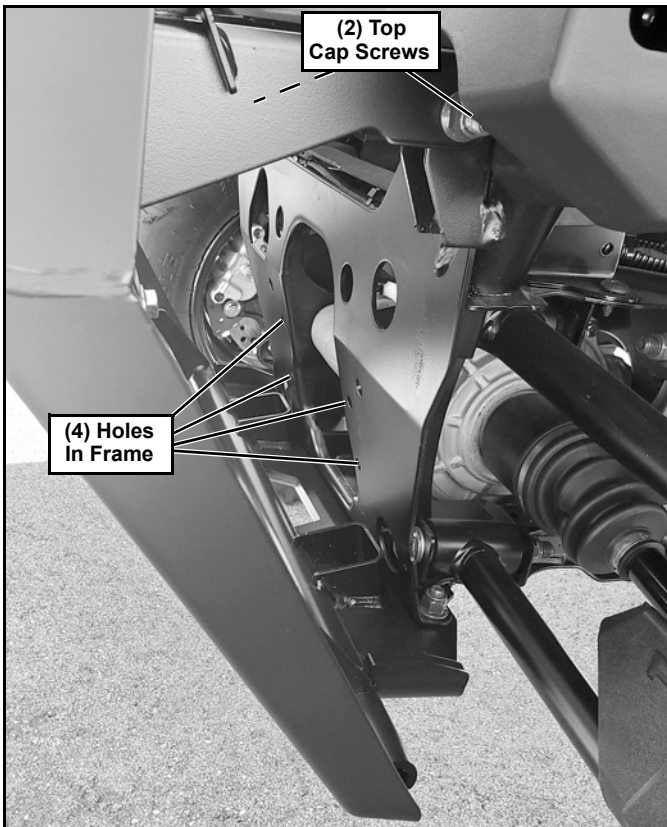

Figure 2

3. Insert (4) 5/16"-18 x 1" Cap Screws (#7) through the Top Weldment (#2) and into the holes on the vehicle frame. Secure with (4) 5/16"-18 Locknuts (#8). (See Figure 3).

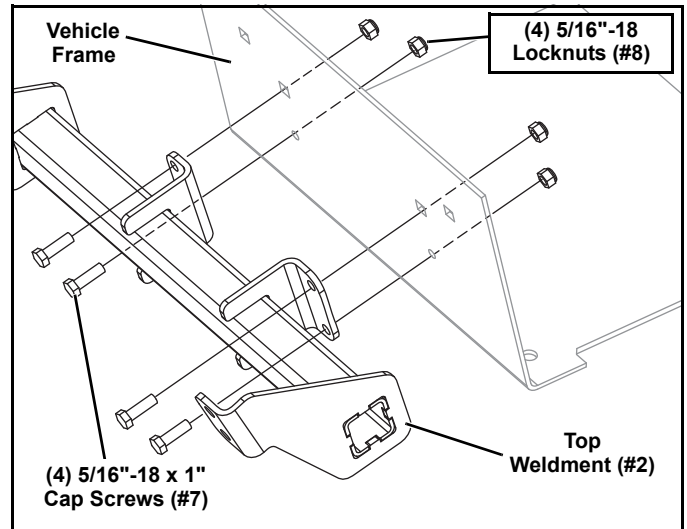

Figure 3

4. Align the two bottom holes in the Bottom Weldment (#3) with the two holes in the bottom of the vehicle frame (that the hardware was removed from in step 1) (See Figure 4).

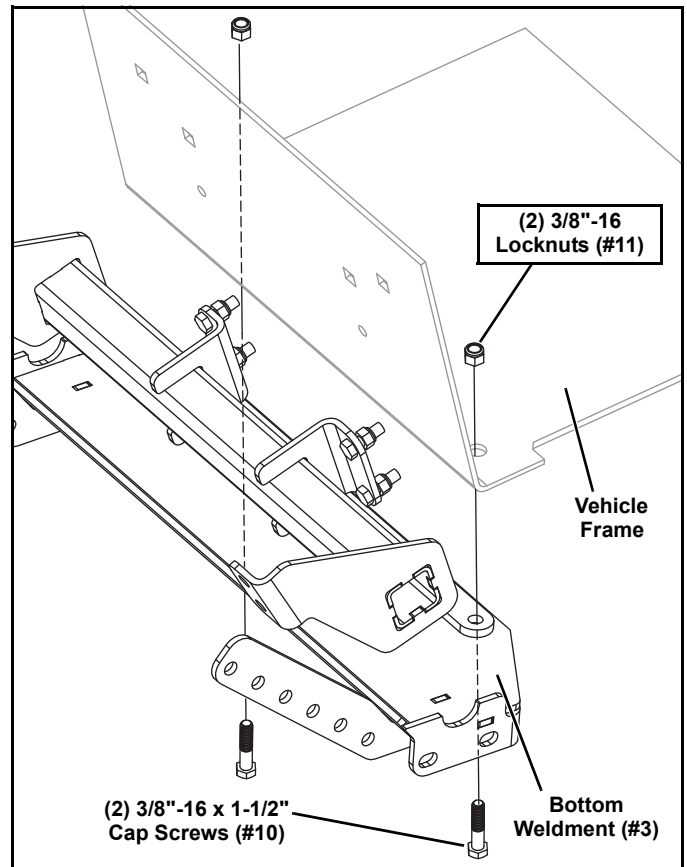

Figure 4

5. Insert (2) 3/8"-16 x 1-1/2" Cap Screws (#10) into the Bottom Weldment (#3) and into the vehicle frame. Secure with (2) 3/8"-16 Locknuts (#11) (See Figure 4).

6. On the driver and passenger side, place a U-Plate (#6) over the tube at the bottom of the brush guard. Secure the U-Brackets (#6) to the Bottom Weldment (#3) with (4) 3/8"-16 x 1-1/4" Cap Screws (#9) and (4) 3/8"-16 Locknuts (#11). (See Figure 5).

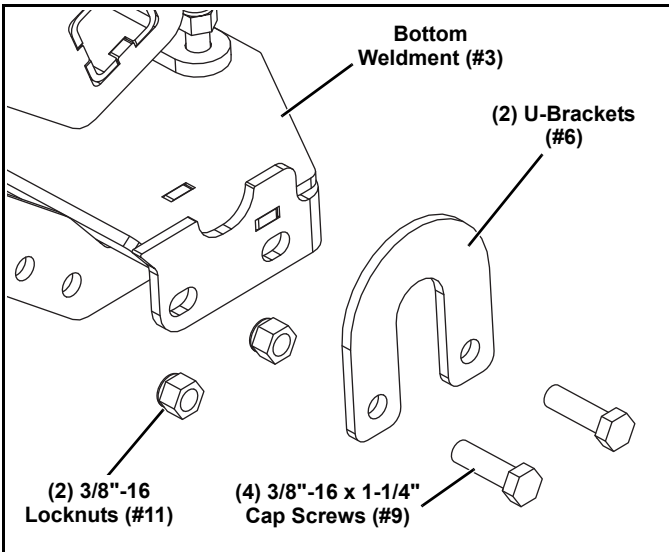

Figure 5

7. Tighten all the hardware and parts that have been installed at this point. (See Figure 6).

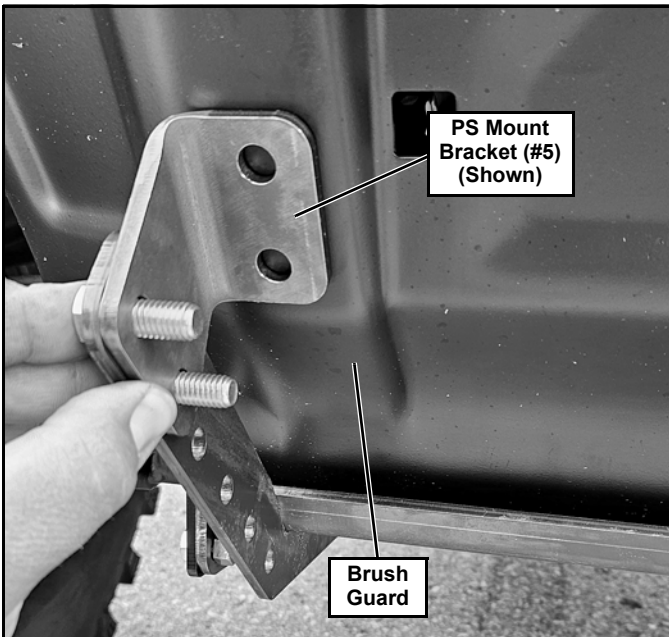

Figure 6

8. Attach the Driver and Passenger Side Mount Brackets (#4 & 5) as shown. Hold tight against the brush guard and use the holes in the parts as a template to center punch and drill to 7/16". (See Figure 6).

9. Use the drilled holes to align and assemble the Driver and Passenger Side Mount Brackets (#4 and 5) to the Top Weldment (#2). Use (4) 3/8"-16 x 1-1/4" Cap Screws (#9) and (4) 3/8"-16 Locknuts (#11). Loosen any hardware necessary to help aid in aligning parts. (See Figure 7).

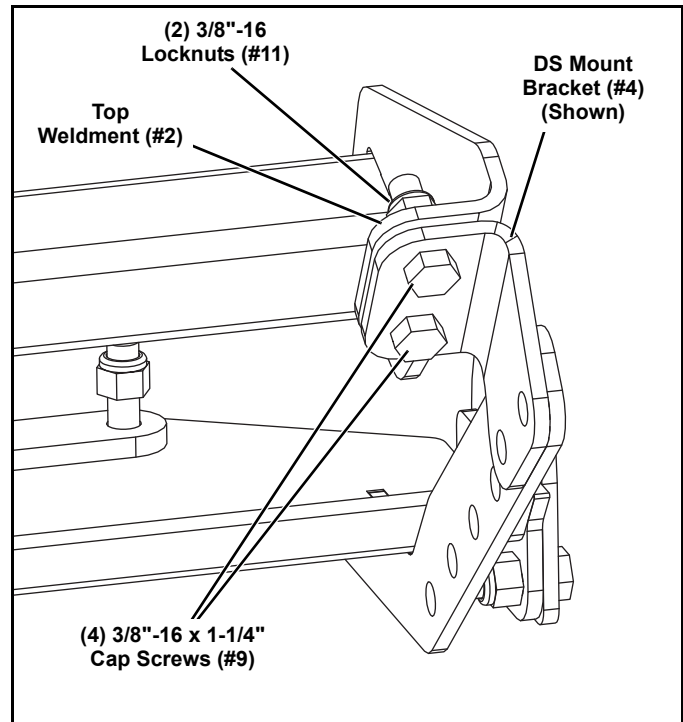

Figure 7

10. Align the UTV Mount (#1) with the front side holes in the Bottom Weldment (#3). Adjust the UTV Mount (#1) so that the center of the bottom slot is 11"-12" off of the ground (See Figure 8).

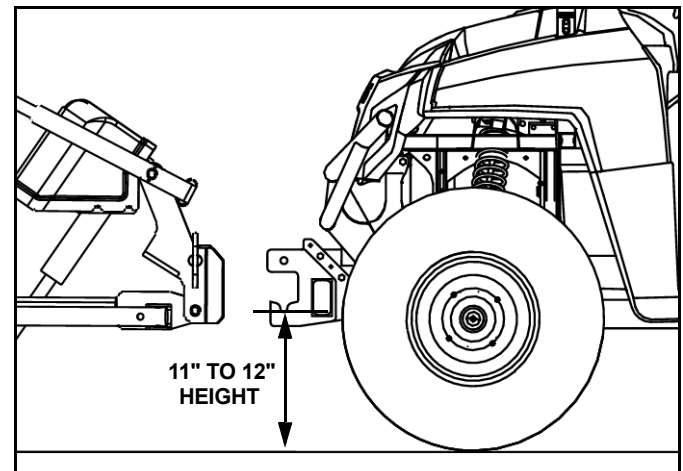

Figure 8

11. Insert (8) 3/8"-16 x 1-1/4" Cap Screws (#9) into the UTV Mount (#1) and through the Bottom Weldment (#3). Secure with (8) 3/8"-16 Locknuts (#11) (See Figure 9).

NOTE: Be sure to keep the Driver and Passenger Side Mount Brackets (#4 & 5) attached to the Bottom Weldment (#3) with the (4) 3/8"-16 x 1-1/4" Cap Screws (#9) and (4) 3/8"-16 Locknuts (#11), no matter what height the UTV Mount (#1) is set at.

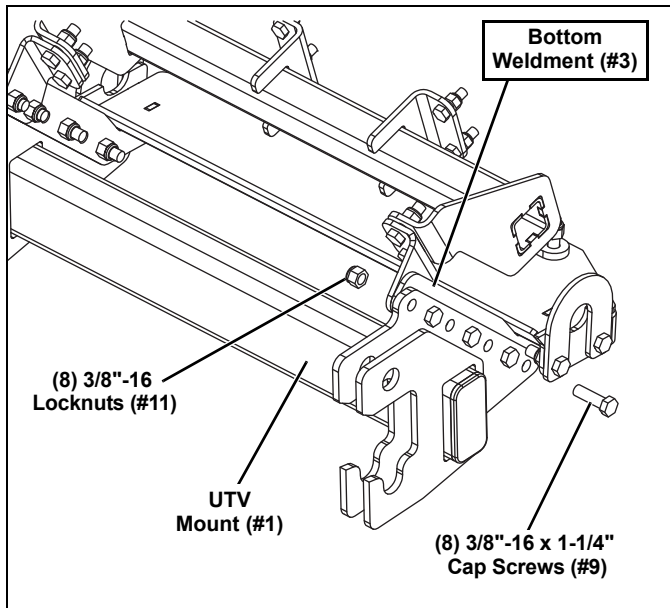

Figure 9

12. Tighten all hardware using the Torque Specification Chart below.

TORQUE SPECIFICATIONS FOR STANDARD MACHINE HARDWARE					
Bolt Size	GR.2 Dry	GR.5 Dry	GR.8 Dry	Metric Size	GR.8.8 Dry
1/4"	66*	9	12	M8	17
5/16"	11	17	25	M10	35
3/8"	20	30	45	M12	60
7/16"	32	50	70	M14	95
1/2"	50	75	110	M16	155
9/16"	70	110	150		
5/8"	100	150	220		
3/4"	175	260	380		
7/8"	170	430	600		
1"	250	640	900		

Note: These torque values are to be used for all hardware. Unless otherwise specified, all torque values must meet this specification.
 Note: All torque values are in Ft.-Lbs unless otherwise stated
 Note: *In-Lbs

NOTE: After 5 to 10 hours of snowplow usage, re-torque all Cap Screws!

PARTS LIST

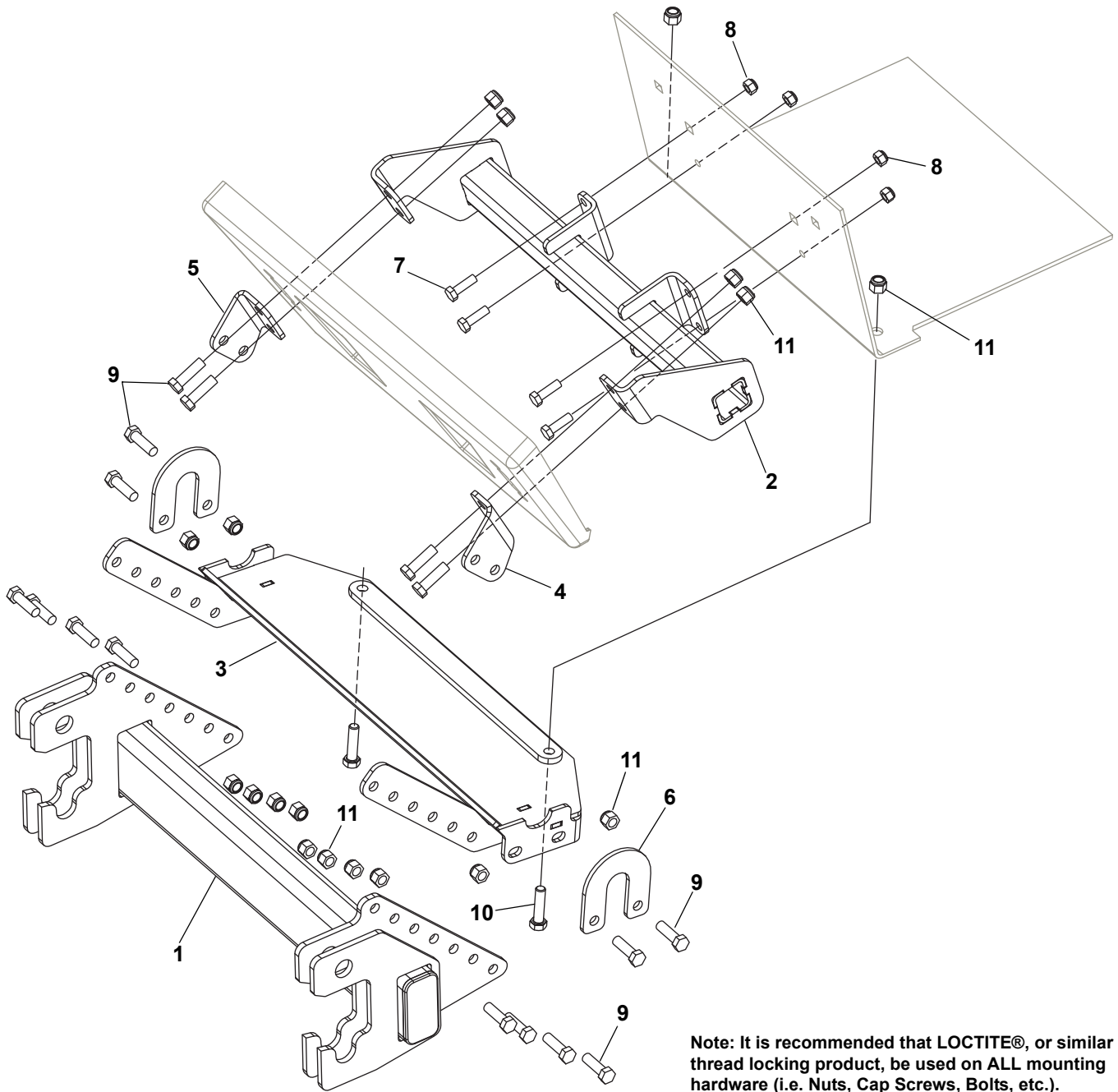

Note: It is recommended that LOCTITE®, or similar thread locking product, be used on ALL mounting hardware (i.e. Nuts, Cap Screws, Bolts, etc.).

ITEM	PART NO.	DESCRIPTION	QTY.
1	96114780	Vehicle Center Member, UTV (Not Included)	1
2		Weldment, Top.....	1
3		Weldment, Bottom	1
4		Bracket, Mount, DS	1
5		Bracket, Mount, PS.....	1
6		U-Plate.....	2
7		HHCS, 5/16"-18 x 1"	4
8		LN, 5/16"-18	4
9		HHCS, 3/8"-16 x 1-1/4".....	16
10		HHCS, 3/8"-16 x 1-1/2".....	2
11		LN, 3/8"-16	18
12	96118965	Kit, HDWE (Includes items 7-11) (Not Shown)	1

NOTES

SNO-WAY® INTERNATIONAL, INC.



Hartford, WI 53027 USA
Website: www.snoway.com
©2024 Sno-Way® International